

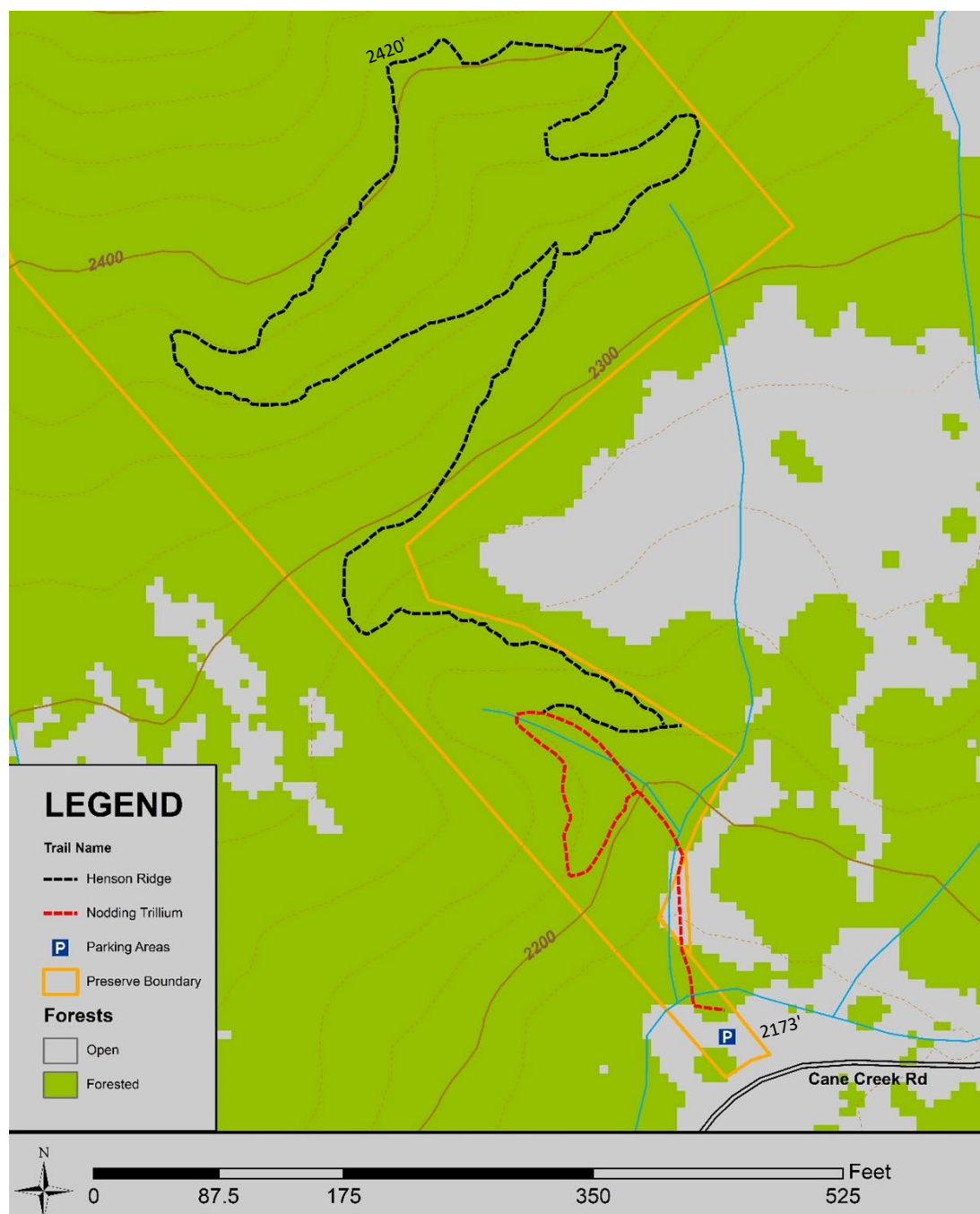

Highlands-Cashiers  
LAND TRUST  
"Saving Special Places since 1909"



# Pittillo Family Nature Preserve



**Trails are open Sunrise to Sunset.**

Trails are closed during heavy rain, snow, and other hazardous weather conditions.

Trails are steep and narrow, with numerous steps. Please proceed with caution and stay on the trails at all times.

The surrounding land is private property. Please stay on the trails at all times.

Picking or removing plants is strictly prohibited. Violators will be treated as trespassers and prosecuted to the fullest extent of the law.

If you notice bad behavior, please contact us at 828-526-1111 or [info@hcltnc.org](mailto:info@hcltnc.org)